

Residential  
Tower

Showroom

Hotel

Bank



Architectural Woodwork Institute

# design solutions

Fall 2019 | \$6.25







# Benchmark Living.

New Residential Tower in Chicago  
is Classically Inspired.





Chicago's One Bennett Park is a 66-story tower that offers rental apartments on the lower half of the building and condominiums on the upper floors, each with their own lobby and amenity suites. The design and construction schedule for the project was from 2015 to 2019. According to the building owner, One Bennett Park is intended as a portrait of the city in which it rises. Beautifully designed inside and out, the building creates a unique immersive experience and sets a new benchmark for residential living.





The architectural firm Robert A.M. Stern Architects, LLP, (RAMSA) New York, New York designed the project. Architectural woodwork was fabricated by D&L Wood Products, Inc., an AWI member firm from Crown Point, Indiana.

"It's a modern traditional building with classically inspired themes interpreted in a 21st century idiom," explains RAMSA's Chris Lee. "Design was achieved through intricate detailing, precisely matching control samples, and delivering superb finishes."

### Warm Walnut

The primary consideration for incorporating woodwork was to create warm and inviting yet luxurious spaces that are expertly crafted, continues Lee. The scope for D&L was for woodwork and wall paneling in both lobbies and amenity spaces encompassed within approximately 15,000 square feet of spaces. "The wood paneling in the lobbies and amenity spaces are meant to give a warm, inviting, club-like feel. Our design relied on sophisticated detailing throughout including sweeping custom profiles, reveals, and floor-to-ceiling wood panels," says Lee.

## at a glance

**AWI MANUFACTURING MEMBER:**

**D&L Wood Products, Inc.**

**LOCATION:**

**Crown Point, Indiana**

**ESTABLISHED:**

**1992**

**EMPLOYEES:**

**50**

The major architectural woodwork includes several rooms and elevations of bleached, dyed, matched and sequenced wall panels through the lobbies and amenities spaces, which includes curved wall panels, curved crown and base, and metal reveals, explains D&L's Adam Ligda. "The apartment and condo lobby front desks combined high-end wood, stone, leather and metal finishes; the mail rooms are both decorated from floor to ceiling with matched and sequenced wood wall panels and applied trims."



WALNUT

The Kid's Room included a wall-to-wall, floor to ceiling custom bookcase, while the fitness room is adorned with matching trims and panels around all the mirrors and columns. Finally, the Cordial Room and Billiards Room were both fitted with full-build, high gloss matched ziricote veneered panels and lockers. D&L also supplied and installed all the architectural wood doors, to ensure that the finish and veneer matched the surrounding millwork.

"One of the biggest challenges to this job was to ensure that the final product matched the designers' samples," notes Ligda. "All the Walnut panels and hardwood had to be bleached by hand several times so that the final stain and color were consistent and matched across all elevations. The White Oak trims and panels in the apartment fitness room introduced a pearlized stain finish, while the Ash veneer and hardwoods also had to be bleached by hand to achieve the consistency needed. The ziricote veneer panels used a full-fill polyurethane finish that was polished and buffed by hand to its final high gloss sheen."

### Most Noteworthy

"The curving wall behind the concierge desk in the condominium lobby is the most noteworthy," says Lee. "It is one of the first features you see as you walk into the condo lobby and it is a curving wall with trim, profiles, and wall panels that all follow the same curve. The craftsmanship is superb and design intent was carried out in a tremendous way."



There was an internal feature stair with structure for the stair already built, he adds. "The complex geometry of the stair required the wood design to be modified in order to clad the stringer with trim. This difficult task was resolved by providing on site mockups, building models, and coordinating with millwork subs on site to ensure everything was built to correct intent."

“ We specialize in the fabrication, supply and installation of architectural millwork for high-end commercial projects and various large-scale hospitality projects across the country.”

– Adam Ligda







Ligda agrees that the curved Walnut wall panels in the condo lobby were one of the most noteworthy woodwork items on the project. “The sheer size of the panels created issues with installation because the panels were so heavy that we had to find a creative solution for drawing the panels together, while still making sure that the panels and trim aligned around the door openings and with the adjacent straight panels.”

Owner representative Denise Hall notes that the condominium lobby is stunning. “The curvature of the space was challenging but the most challenging was achieving the color and finish that we wanted. D&L provided many rounds of samples and mock-ups in order to achieve a perfect match and I believe the results are noteworthy and spectacular.”



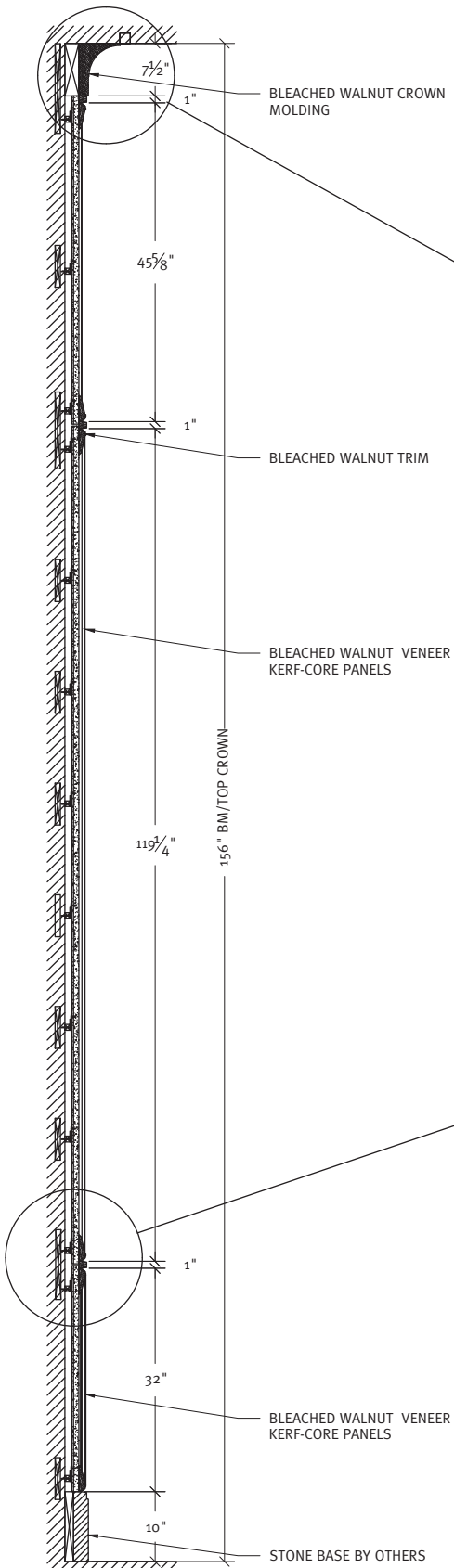

SECTION  
@ CURVED LOBBY WALL PANELS

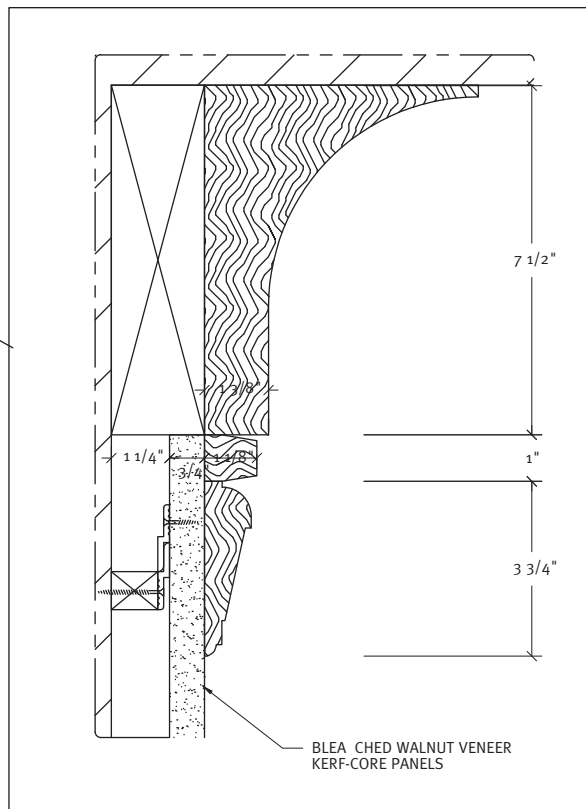

DETAIL  
@ BLEACHED WALNUT CROWN & TRIM

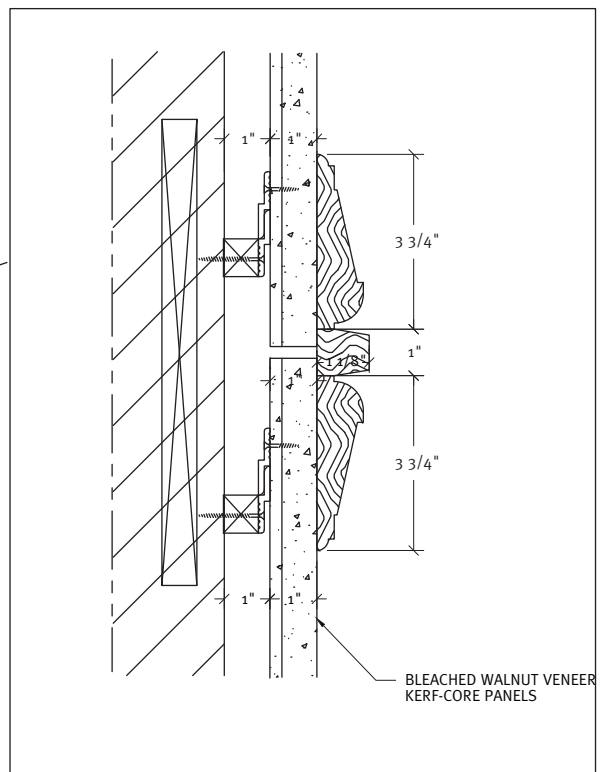

DETAIL  
@ BLEACHED WALNUT PANEL MOLDING



## True Teamwork

"We worked closely with D&L throughout the process," adds Hall. "They are very skilled craftsmen and the service they provide is exceptional. D&L's team was always informative, knowledgeable, and thorough with all of the intricate details of the design."

The most challenging aspect of the project was using propriety finish samples and having the woodworking firm match them, says Lee. "Tweaking colors and graining of the wood was something that was difficult to express through markups or words. However, through trial and error we worked as a team to achieve the look that pleased everyone. D&L also provided special assistance by participating in special workshops to review control



samples and discuss how to best achieve matching of the control samples. The woodworking firm was very gracious about providing ample submittal samples in order to go through many rounds of finishes to achieve the desired look."

"We had a very good working relationship with RAMSA and the building owner's design team," adds Ligda. "There were many intricate details that were addressed by our team and coordinated with them at various stages of the project. We introduced weekly phone calls with the team to focus on shop drawing reviews, design details, and finish submittals, to name a few." 

PROJECT:  
**One Bennett Park**  
Chicago, IL

PROJECT OWNER:  
**Related Midwest**  
Chicago, IL

WOODWORKER:  
**D&L Wood Products, Inc.**  
Crown Point, IN

ARCHITECT:  
**Robert A.M. Stern  
Architects, LLC**  
New York, NY

GENERAL CONTRACTOR:  
**Lend Lease**  
Chicago, IL

PHOTOGRAPHER:  
**Dan Ham**  
Dallas, TX





MUSEUM QUALITY IS OUR STANDARD



D&L Wood Products, Inc.  
617 N. Indiana Avenue, Crown Point, IN 46307  
[www.DLwoodproductsinc.com](http://www.DLwoodproductsinc.com)  
Phone : (219) 662-9177 | Fax : (219) 662-9572